

GENERAL DESCRIPTION

This micro miniature size connector series is an excellent design where weight and space are vital. This connector series has a quick snap-on locking mechanism. The MCX series is used with small, semi-rigid and flexible cables. These connectors can also accommodate various PCB, bulkhead, surface, edge, and press fit mount configurations. MCX connectors are ideal for the cellular telephone, information systems and communications markets.

MATERIALS

Bodies & Other Parts: Brass per ASTM B16 or equivalent.
 Female Contacts: Beryllium Copper per ASTM B196 or equivalent.
 Male Contacts: Brass per ASTM B16 or equivalent.
 Insulators (Dielectric): PTFE Fluorocarbon per ASTM D1710 or equivalent.

ELECTRICAL

Impedance: 50 Ohms Nominal
 Frequency Range: DC-6 GHz
 Insulation Resistance: 5,000 Megohms min.
 Voltage Rating: 335 VRMS
 Dielectric Withstanding: 1,000 VRMS at sea level
 Voltage Standing Wave Ratio (VSWR): 1.30 max.
 Contact Resistance:
 Outer Contact: 5.0 Milliohms
 Center Contact: 1.0 Milliohms

ENVIRONMENTAL

Temperature rating: -65°C to +165°C
 Vibration: MIL-STD-202, Method 204
 Shock: MIL-STD-202, Method 213
 Thermal Shock: MIL-STD-202, Method 107
 Corrosion (Salt Spray): MIL-STD-202, Method 101
 Moisture Resistance: MIL-STD-202, Method 106

PLATING OPTIONS

Gold: Per MIL-G-45204, Type II, Grade C
 Nickel: Per QQ-N-290, Class II
 Silver: Per QQ-S-365, Type II, Grade A

MECHANICAL

Force to Engage and Disengage:
 Engagement: 6 lbs max., 2.5 lbs min.
 Disengagement: 4 lbs max., 2.0 lbs min.
 Mating Cycles: 500 min.

DESIGN IN ACCORDANCE WITH

CECC: 22 220
 INTELLICONNECT: ES101, ES103

JACK INTERFACE
(FEMALE CONTACT)

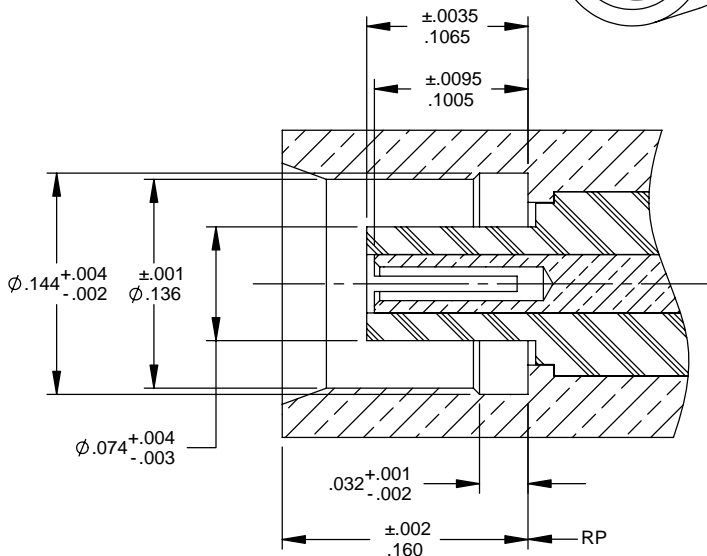
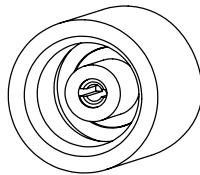

PLUG INTERFACE
(MALE CONTACT)

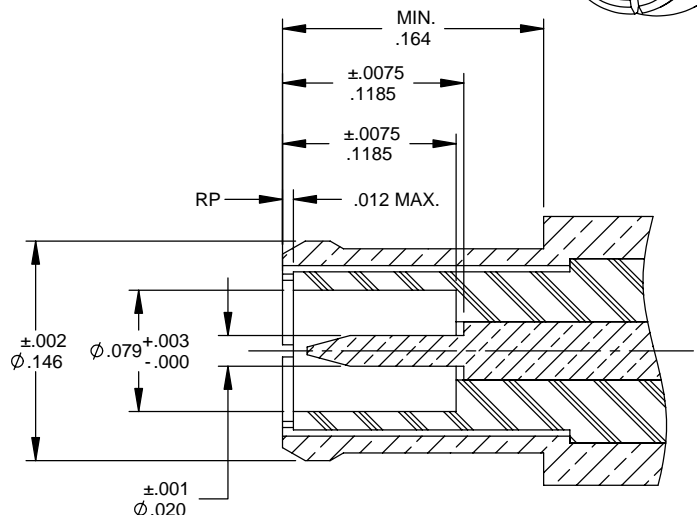
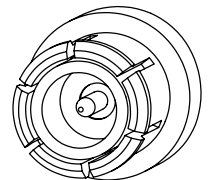

*These specifications are typical and may not apply to all connectors. Please contact the factory for detailed specifications for individual connectors. For clarity, interface illustrations are not drawn to scale. All dimensions are in inches. Interface dimensions are designed per documents above.