

**MECHANICAL/ELECTRICAL PROPERTIES**

CONNECTOR MEETS: MIL-STD-348, FIG. 311-1, MIL-PRF-39012  
 CONNECTOR MEETS: RoHS 2002/95/EC STANDARDS  
 CONNECTOR DURABILITY: 500 CYCLES MIN.  
 PANEL THICKNESS: .125 [3.2] MAX.  
 BULKHEAD MOUNTING: PER ES117-BK050  
 PCB MOUNTING: PER ES117-PC050  
 IMPEDANCE: 50 OHMS (NOMINAL)  
 FREQUENCY RANGE: DC-2 GHZ  
 INSULATION RESISTANCE: 1,000 MEGOHMS  
 VOLTAGE RATING: 335 VRMS

**MATERIAL/FINISH PROPERTIES**

**MATERIAL PROPERTIES:**  
 BODIES: BRASS PER ASTM B16 OR EQUIVALENT  
 CONTACT: BERYLLIUM COPPER PER ASTM B196 OR EQUIVALENT  
 INSULATORS: PTFE PER ASTM D1710 OR EQUIVALENT

**PLATING PROPERTIES:**  
 BODY 1: .000024 MIN. GOLD PER MIL-G-45204 OVER  
 .000050 MIN. NICKEL PER QQ-N-290  
 BODY 2: .000100 MIN. NICKEL PER QQ-N-290  
 CONTACT: .000024 MIN. GOLD PER MIL-G-45204 OVER  
 .000050 MIN. NICKEL PER QQ-N-290

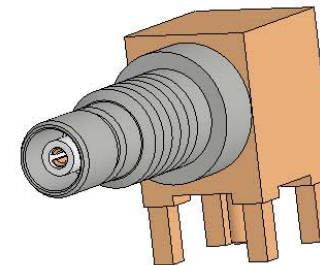

**IntelliConnect**

**TITLE:** SMB POLARIZED RIGHT ANGLE PCB MOUNT JACK

**MATERIAL & FINISH:** PER TABLE ABOVE

C	ECN 1137	TLB	09/06/06
B	ECN 1015	REC	11/05/01
A	REL. FOR PRODUCTION	REC	08/10/01
<b>REV</b>	<b>DESCRIPTION</b>	<b>APPR</b>	<b>DATE</b>

**UNLESS OTHERWISE SPECIFIED**  
 ALL DIMENSIONS ARE REFERENCE  
 X.XXX DIM'S = INCHES \* [X.XX] DIM'S = MILLIMETERS  
 SURFACE FINISH: 63 MICRO MAX.  
 ALL DIAMETERS TO BE CONCENTRIC WITHIN .005 F.I.M.

<b>DRAWN BY:</b> TLB	<b>CHECK BY:</b> PCS	<b>APPR. BY:</b> TDB
<b>DATE:</b> 08/10/01	<b>DATE:</b> 08/10/01	<b>DATE:</b> 08/10/01
<b>CAGE CODE NO:</b> 5N5S5	<b>SCALE:</b> 4:1	<b>SIZE:</b> A
<b>SALES DRAWING</b>	<b>PART NO.</b> 5132-Z2PC-000-100G	<b>REV</b> C
		<b>SHEET</b> 1 OF 1