

MATERIAL/FINISH PROPERTIES

MATERIAL PROPERTIES:
 BODY: STAINLESS STEEL TYPE 316 PER ASTM A276
 CONTACT: BERYLLIUM COPPER PER ASTM B196 OR EQUIVALENT
 INSULATOR: PTFE PER ASTM D1710 OR EQUIVALENT
 O-RINGS: SILICONE RUBBER PER AA59588 OR EQUIVALENT

PLATING PROPERTIES:
 BODY: PASSIVATE PER QQ-P-35, TYPE II
 CONTACT: .000030 MIN. GOLD PER MIL-G-45204 OVER
 .000050 MIN. NICKEL PER QQ-N-290

MECHANICAL/ELECTRICAL PROPERTIES

CONNECTOR MEETS: CECC22 000, MIL-PRF-39012, MIL-STD-348
 CONNECTOR MEETS: RoHS 2002/95/EC STANDARDS
 CONNECTOR DURABILITY (MMCX): 500 CYCLES MIN.
 CONNECTOR DURABILITY (SSMA): 500 CYCLES MIN.
 MOUNTING PER: ES117-BK300
 PANEL THICKNESS: .156 [4.0] MAX.
 IMPEDANCE: 50 OHMS NOMINAL
 FREQUENCY RANGE: DC-6 GHZ
 VOLTAGE RATING: 170 VRMS
 INSULATION RESISTANCE: 1,000 MEGOHMS
 TEMPERATURE RATING: -65°C TO +165°C

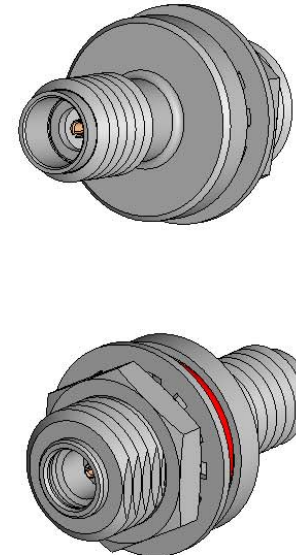
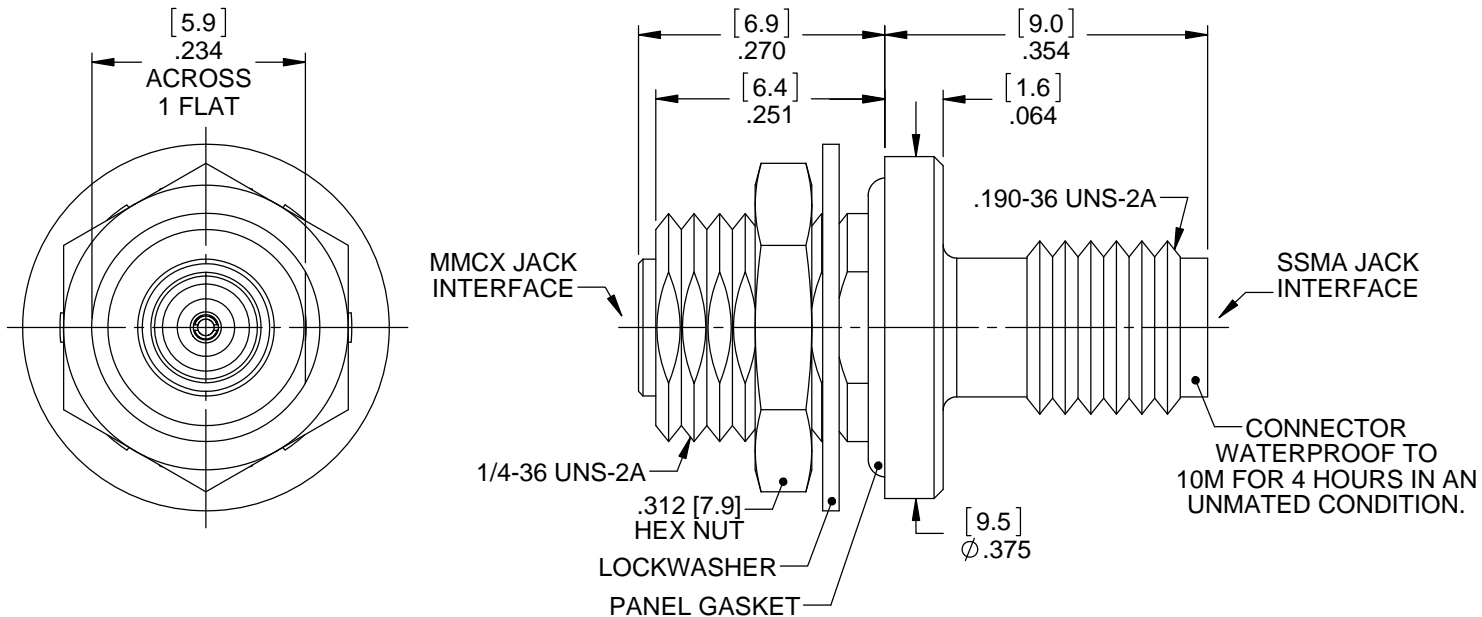

UNLESS OTHERWISE SPECIFIED
 ALL DIMENSIONS ARE REFERENCE
 X.XXX DIM'S = INCHES * [X.XX] DIM'S = MILLIMETERS
 SURFACE FINISH: 63 MICRO MAX.
 ALL DIAMETERS TO BE CONCENTRIC WITHIN .005 F.I.M.

TITLE: SSMA JACK TO MMCX JACK SEALED BULKHEAD MOUNT ADAPTER - SS316 BODY

MATERIAL & FINISH: PER TABLE ABOVE

DRAWN BY: SRS	CHECK BY: PCS	APPR. BY: TLB
DATE: 10/09/13	DATE: 10/09/13	DATE: 10/09/13

CAGE CODE NO: 5N5S5	SCALE: 5:1	SIZE: A	REV: A
---------------------	------------	---------	--------

SALES DRAWING	PART NO. A5685-1BK-101P	SHEET 1 OF 1
---------------	-------------------------	--------------

A	NPR 960U	TLB	10/24/13
REV	DESCRIPTION	APPR	DATE